

# PEHRATEK WIRELESS VIDEO VRA RF 2.0

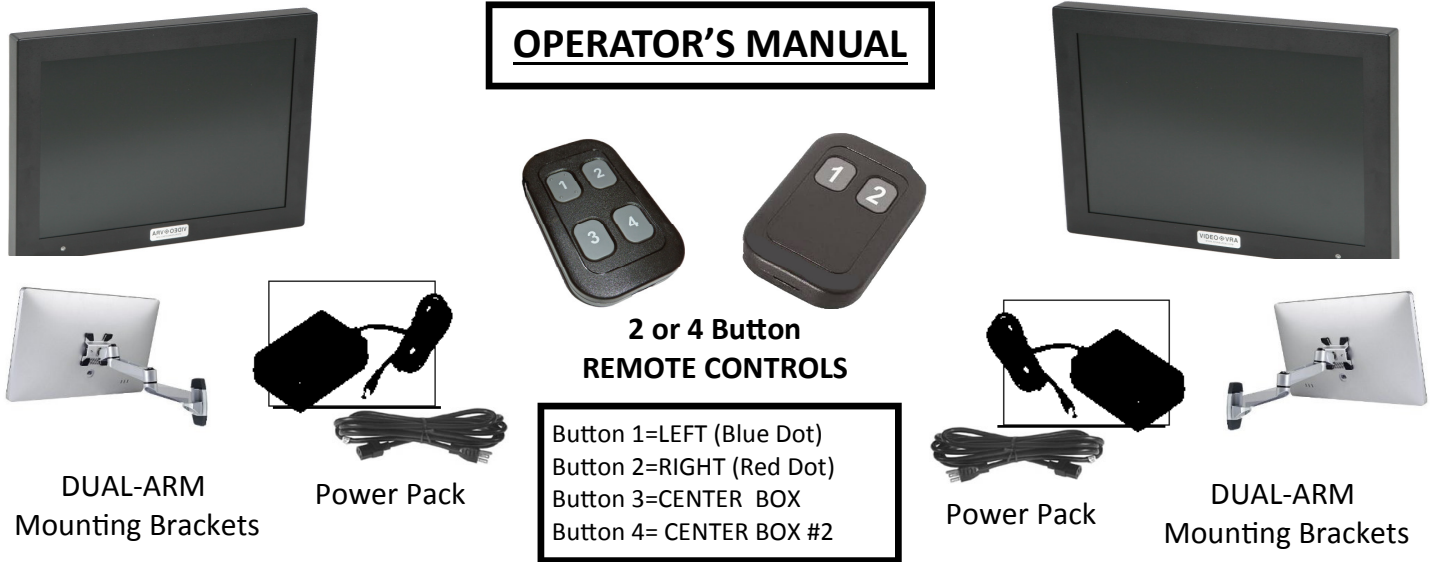

## INSTALLATION INSTRUCTIONS

- 1.) Position VIDEO VRA near sound field loudspeakers using table-top mount, rolling cart, or wall mounting brackets. Assure each panel's secure mounting to the wall or sound field speakers. Right/left assignment is indicated by a red=right dot in upper corner.
- 2.) Route power pack power cords to nearest AC outlet. Secure cords to wall using Installation Kit (optional)
- 3.) Elongate RF antennas on back of video displays and position away from the metal case and sound room walls. Aiming the antenna towards window will improve performance.
- 4.) Test wireless remote control to assure proper activation



**SMALL THIN REMOTE**

(See separate instruction sheet on using this remote control Enclosed)

Used only to control:

- Brightness
- Contrast
- Volume
- Mute

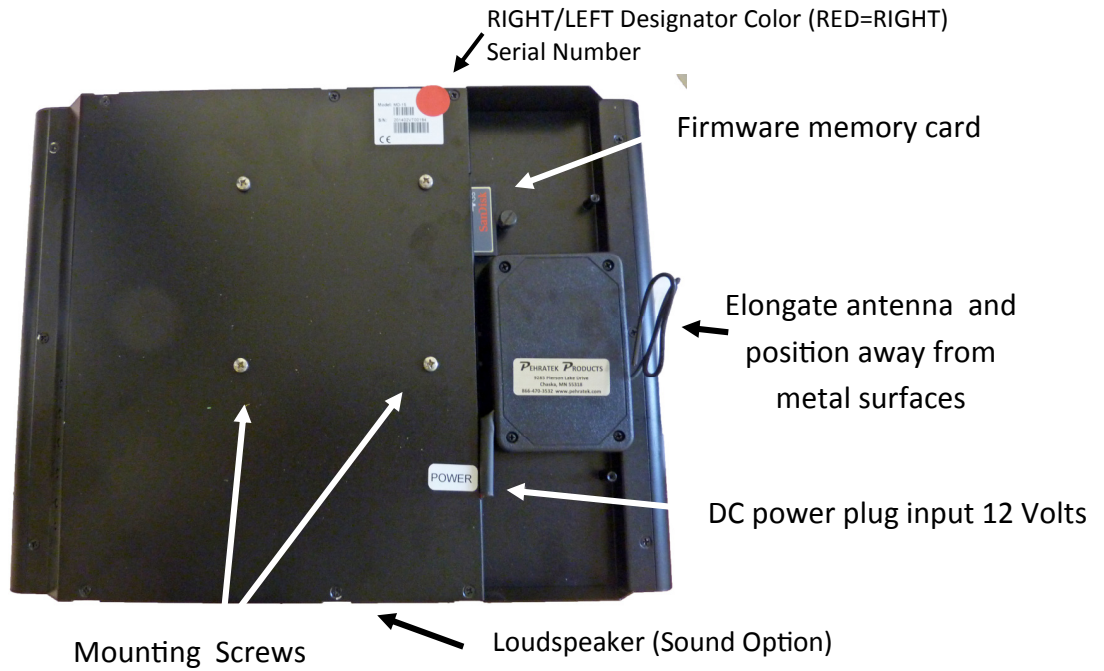

# TROUBLESHOOTING

<b>PROBLEM</b>	<b>POSSIBLE CAUSE/REMEDY</b>
Display will not light up	Check power connections, look for glowing green LED on side panel, make sure outlet is live
Activates intermittently	Make sure that antennas are outstretched and away from metal case and sound walls Replace battery in remote control 2 (CR-2016), add extended range antenna (optional)
No images are shown	Check that the file counter (next to the RF module) is on number #9
Images are distorted	Unplug unit from outlet for 3 minutes, restart system, Replace memory card

## SOUND OPTION

Sounds will accompany each presentation when RIGHT/ LEFT side is activated. Use the small thin remote to MUTE or change volume settings.

NOTE: To change battery in remote control-remove two screws on back side and lift top off bottom half. Replace with CR-2016 3 volt lithium batteries (positive facing upward) reinstall screws.

## TO PAIR REMOTE WITH VIDEO MONITOR PANEL

- 1) Remove RF module cover (4 screws on top plate)
- 2) Locate push buttons at the top of the PC board facing the memory card.
- 3) Press channel program switch and hold for 3 seconds
- 4) The red or green LED will flash at the bottom of the PC board. (RED=RIGHT) (GREEN=LEFT)
- 5) While the LED is flashing, press the button of the remote control to be paired one time. The LED will flash once to confirm successful pairing. The RF module will automatically exit the pairing mode in 15 seconds.

**PEHRATEK PRODUCTS**  
**9285 Pierson Lake Drive**  
**Chaska, MN 55318**  
**(952) 470-9063**  
**www.pehratek.com**

## OPTIONAL ACCESSORIES

### **DUCK CENTER BOX LPV-300**



### **MOVING DOG CENTER BOX LPA-440**



### **EXTENDED RANGE ANTENNA ANT-001**



### **INSTALLATION KIT INS-VID**

